

State of South Carolina

(202)

Pursuant to a warrant from John Thomas Esq. Commissioner of Locations dated 26th day of Sept. 1784, I have admeasured and laid out unto Susanna Meharg a tract of 363 acres of Land situate in Ninety six district below the ancient boundary line North of Saluda River on a branch of Mehurns Creek called the Rich Creek bounded W on William Williamson's land, all other sides on Vacant land, and hath such shape and Marks as the annexed Plat represents, Survey 5th Oct. 1784

Recorded 15 Nov. 1784

John Th. Downs De.

Deliv. not. ~~not~~

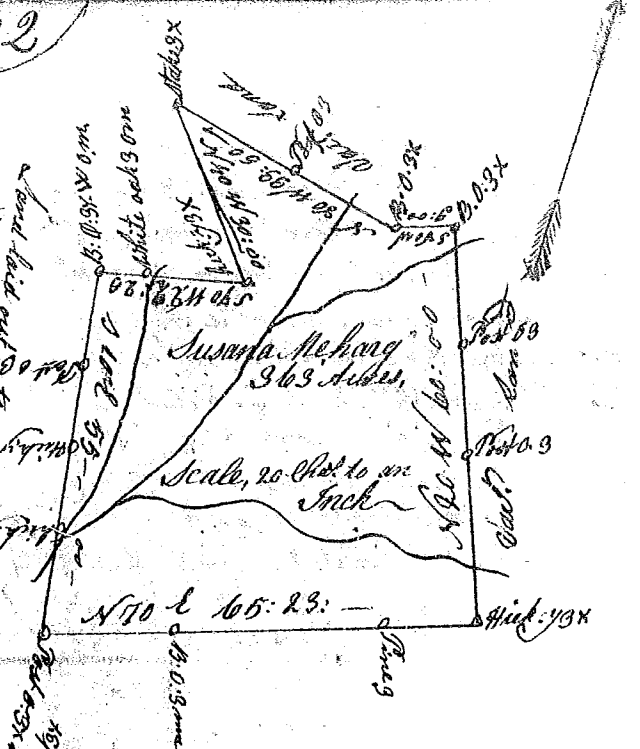

State of South Carolina

Pursuant to a warrant from John Thomas Esq. Commissioner of Locations dated 5th day June 1784 I have admeasured and laid out unto Robert Bolt a tract of 300 acres of Land situate in 96 district below the ancient boundary line So of Saluda on a branch of Rich Creek, called the Hilly Branch bounding No on Susanna Meharg land, all other sides on Vacant land and hath shape and Marks as the annexed Plat represents, Survey the 6th Oct. 1784 John Th. Downs De.

Recorded 15 Nov. 1784

Deliv. not. Bolt.

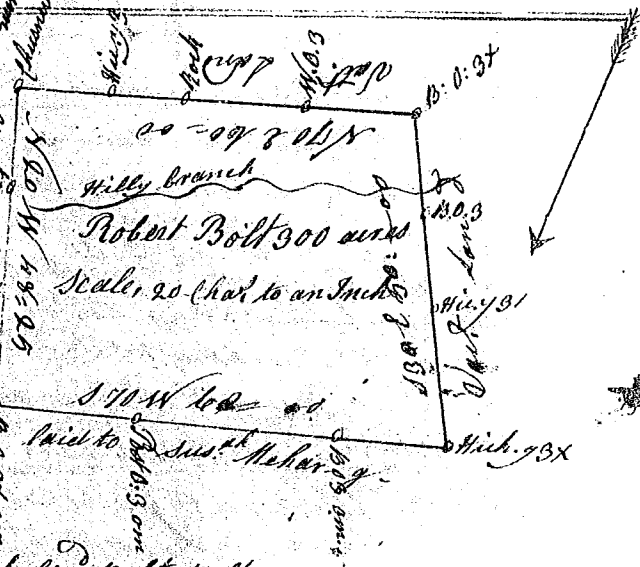

South Carolina

Pursuant to a warrant directed by John Thomas Esq. Commissioner of Locations for Ninety six district North side of Saluda River dated 25th Aug. 1784 I have admeasured and laid out unto Aaron Kemp a tract of Land containing two hundred acres situate lying and being on the So. part of Braushy Creek a branch of Enoree River on the South side bounding on all sides on Vacant land and hath such shape form and Marks as the above Plat represents, Survey 30 Aug. 1784 Thos Lewis De.

Recorded 16th Nov. 1784

Thos Lewis De.



South Carolina

Pursuant to a warrant directed by John Thomas Commissioner of Locations for Ninety six district No. of Saluda River dated 28 July 1784 I have admeasured and laid out unto Aaron Kemp a tract of Land containing one hundred acres situate lying and being on Braushy Creek a branch of Enoree River on the South side bounding N on Jonathan Shufflett's land all other sides on Vacant land and hath such shape form and Marks as the above Plat represents, Survey 15th Aug. 1784

Recorded 15 Nov. 1784

Thos Lewis De.

